

APPROVED



For exploded diagram and part number information, refer to the Spare Parts Catalog available on our website at www.rockshox.com.

Contact your local distributor or visit the RockShox website at www.rockshox.com for ordering information.

Information contained in this publication is subject to change at anytime without prior notice.
For the latest technical information, visit our website at www.rockshox.com.
Names used in this manual may be trademarks or registered trademarks of others.

TOOLS NEEDED

- 5 mm Hex Wrench
- 10 and 24 mm Socket
- Torque Wrench
- Plastic Face Mallet
- Snap ring pliers
- Small Blade Screwdriver
- SID Cartridge Retainer Tool (for SID Only)
- 12" long cylindrical rod (plastic or wood)
- Biodegradable Cleaning Solvent (Simple Green, Pedros, Isopropyl Alcohol)
- RockShox 5 wt. Oil
- RockShox RedRum
- Safety Glasses
- Oil Pan

After every 100 hours of riding, or less depending on riding conditions and riding style, the following service should be performed. This service should be performed by a qualified mechanic, using proper tools.

NOTE: SERVICE ON YOUR FORK MAY BE PERFORMED WHILE STILL INSTALLED ON YOUR BICYCLE. THOROUGHLY READ THIS GUIDE BEFORE PERFORMING SERVICE ON YOUR PRODUCT. NOTE WHAT KIND OF KITS/PARTS YOU MAY NEED TO REPLACE. SEE THE SPARE PARTS CATALOG FOR A COMPLETE LIST OF PART #S AND EXPLODED VIEWS. ALWAYS WEAR SAFETY GLASSES WHEN YOU ARE WORKING ON YOUR FORK!

FOR INFORMATION REGARDING PURE SYSTEM SERVICE, REFER TO THE PURE SYSTEM SERVICE GUIDE ON OUR WEBSITE AT WWW.ROCKSHOX.COM.

REMOVE LOWER TUBE ASSEMBLY

FOR SERVICE INFORMATION REGARDING 02 DUKE RACE, SEE THE 02 DUKE SERVICE GUIDE.

1. Remove the air cap from the top cap and deflate the positive air chamber. Then remove the air cap from the negative valve and deflate the air from the negative air chamber.
2. Gently pull downward to remove the rebound adjuster knob from the right shaft bolt.

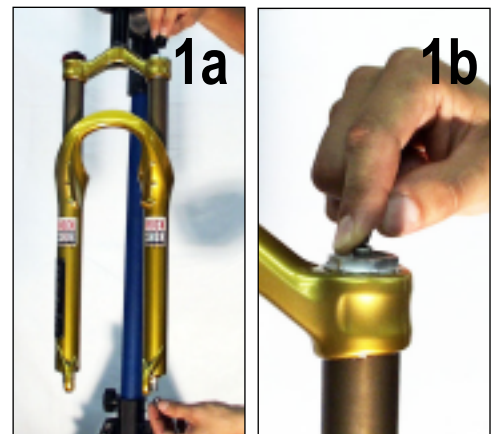

3. Using a 5 mm hex wrench, loosen the right damper shaft bolt five turns or halfway. Using a 10 mm socket, loosen the left shaft nut until it is flush or just beyond with the dual air shaft end.

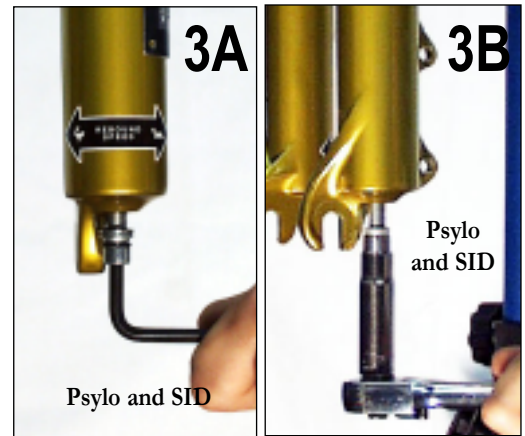

4. Tap the rebound shaft bolt and dual air shaft nut firmly with a plastic faced mallet to separate the shafts from the lower leg press-fit. Keep a bucket or oil pan below the fork to catch the oil. Inspect the condition of removed oil.

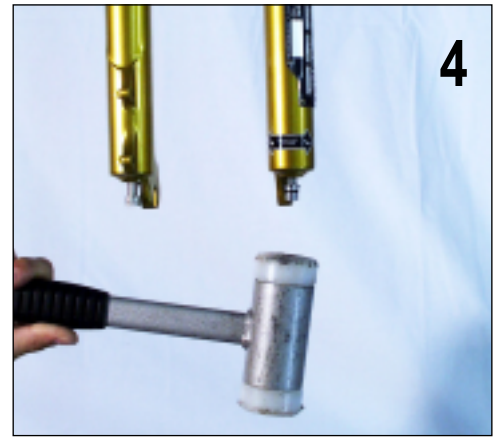

5. Remove the shaft bolts completely. Carefully slide the lower tube assembly off of the upper tubes. Use the bucket to catch the excess oil. If the oil is opaque and/or milky (water contamination), the lower tube assembly should be cleaned thoroughly with isopropyl alcohol. Inspect the dust seals, foam rings and bushings for wear and replace as necessary.
6. Apply biodegradable solvent (Simple Green, Pedros, or isopropyl alcohol) to a clean rag and use a long cylindrical rod or screwdriver to clean the lower tube internals. Dry thoroughly.

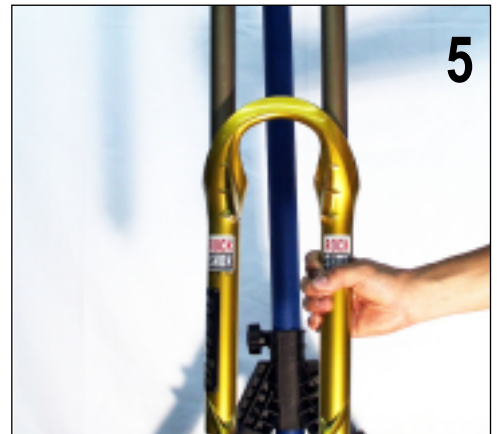

NOTE: CHECK THE LOWER LEG BUSHINGS FOR LOOSE FIT OR WEAR. REPLACE IF NECESSARY. REFER TO THE BUSHING INSTALLATION GUIDE FOR PROPER BUSHING REPLACEMENT PROCEDURES.

REMOVE THE DUAL AIR ASSEMBLY

7. Using a 24 mm socket wrench, remove the air top cap. Inspect and clean the air top cap and air valve using isopropyl alcohol. Replace valve core and top cap o-ring if necessary.

NOTE: ENSURE ALL AIR IS REMOVED BEFORE REMOVING THE TOP CAP.



8. **Psylo Race:** With curved snap ring pliers, remove the dual air snap ring (fig. 8a). Slide the dual air assembly (with air tube) out of the upper tube.



SID: Using the SID threaded base retainer tool and a socket wrench, remove the dual air assembly (fig. 8b).



IMPORTANT: THE SID DUAL AIR CARTRIDGE RETAINER IS REVERSE THREADED, TURN CLOCKWISE FOR REMOVAL. RIGHTY-LOOSEY, LEFTY-TIGHTY!

9. **Psylo Race:** Gently pull the white base valve from the air tube and remove the dual air assembly (fig. 9a).



SID: Gently pull the dual air assembly from the upper tube (there is no air tube as seen in the Psylo Race) (fig. 9b).

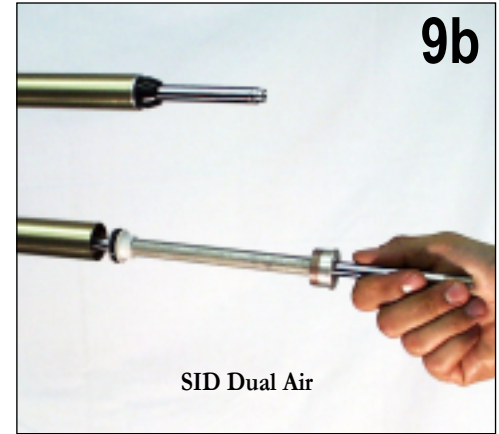

CLEAN AND INSTALL THE DUAL AIR ASSEMBLY

10. Clean and inspect the o-rings, base plate and wave washers on the dual air assembly. O-rings should be inspected for nicks, tears or cracks. Replace the o-rings and grease as necessary.
11. Inspect air tube (Psylo Race, fig. 11) and upper tubes for scratches or other damage. Replace as necessary. Apply biodegradable solvent (Simple Green, Pedros, or isopropyl alcohol) to a clean rag and use a long cylindrical rod or screwdriver to clean the inside of the air tube (Psylo Race) and upper tube. Dry thoroughly.

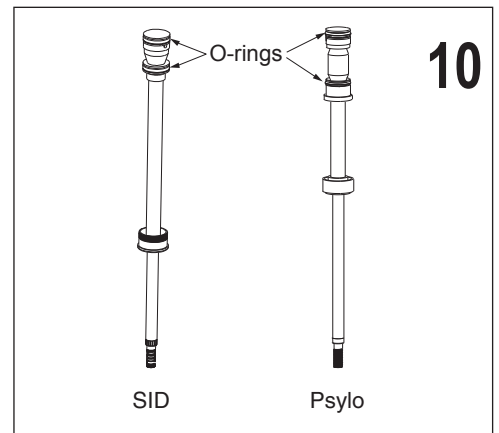

NOTE: SCRATCHES ON THE INSIDE OF THE UPPER TUBE SURFACE WILL CAUSE AIR BYPASS.

12. Apply a light coating of oil soluble grease or RedRum to the o-ring(s) on the dual air assembly. Insert the dual air assembly into the air tube
13. **Psylo Race:** Gently slide the air tube (with dual air assembly) back into the bottom of the upper tube. Press the base plate assembly firmly into the air tube. Insert the snap ring with the **sharpest side towards the end of the upper tube**. This ensures the snap ring stays in the upper tube.

SID: Gently slide the dual air assembly back into the upper tube and torque the cartridge retainer to 20 in-lb. **Remember, the cartridge retainer has reverse threads (fig 8b)!**



REFILL FLUIDS

16. Pour 3-5cc of RockShox suspension oil or RedRum into the top of the upper tube on top of the air piston. This will ensure long o-ring life, smooth stroke and less friction.

NOTE: CHECK AND REFILL THIS OIL OFTEN!

17. Using a 24 mm socket, install the air top cap.

18. Slide the lower tube assembly onto the upper tube assembly. Stop when you feel the lower bushing engage the upper tube.

IMPORTANT: ENSURE THE GREY DUST SEALS ARE PROPERLY SEATED IN THE LOWER LEGS.

19. Invert the fork and pour 10 cc of RockShox 5 wt. oil into the bottom of both sides of the lower leg.

20. Slide the lower tubes completely onto the upper tubes until the shaft fully engages the lower tubes.

21. **BEFORE** installing the rebound adjuster knob into the hollow shaft bolt, insert the knob into the damper and turn the rebound valve to the full clockwise position. Then remove the knob. **THIS PREVENTS DAMAGE TO THE PLASTIC REBOUND ASSEMBLY IN THE SHAFT (FIG. 2).**

22. Inspect the nylon crush washers for wear or damage and replace if necessary.

23. Install hollow shaft bolt and torque to 60 in-lb. Firmly press the rebound adjuster knob into the hollow shaft bolt.

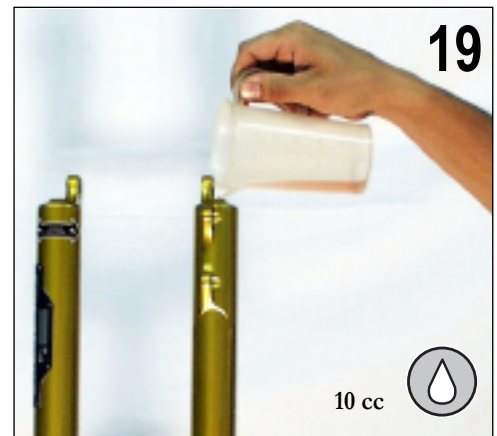
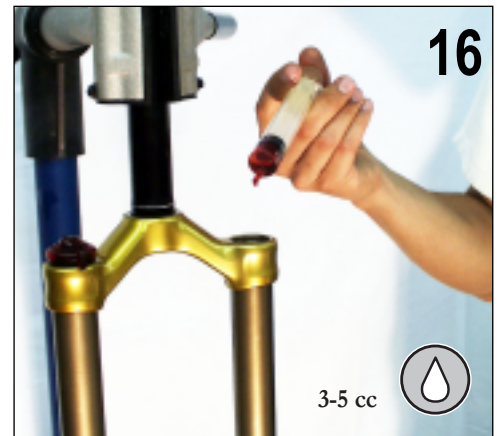

AIR PRESSURE GUIDELINES

24. Using a 10 mm socket, install the dual air shaft nut. Torque to 45 in-lb.

25. Using a RockShox Air Pump (w/schrader valve), add the recommended **positive air pressure**.



Rider Weight (lb)	Psylo Race	SID
	Air Pressure	Air Pressure
<120 (55 kg)	70-80 psi	70-80 psi
120-140 (55-65 kg)	80-100 psi	80-100 psi
140-160 (65-73 kg)	100-120 psi	100-120 psi
160-180 (73-82 kg)	120-140 psi	120-140 psi
>180 (82 kg)	140-180 psi	140-160 psi

26. Then add desired **negative air**.

PSYLO	
Ride Weight (lb)	Air Pressure
<140 (63 kg)	60-115 psi
140-160 (63-72 kg)	95-130 psi
160-180 (72-81 kg)	110-145 psi
180-200 (81-90 kg)	125-160 psi
>220 (99 kg)	160-180 psi

SID		
Rider Weight	X C	Racing
>120lb (55 kg)	70-80 psi	40-60 psi
120-140lb (55-65 kg)	80-100 psi	60-80 psi
140-160lb (65-73 kg)	100-120 psi	80-100 psi
160-180lb (73-82 kg)	120-140 psi	100-120 psi
>180lb (82 kg)	140-160 psi	120-140 psi

27. Install the air caps.

28. Spray the entire fork with isopropyl alcohol and wipe down with a clean rag.